

ART. SSC-G Dritto filetto cilindrico maschio
Straight male parallel adaptor

CODICE	ØD	G	L1	L2	ØD1	⊙	↷	📦
SSC04-M5	4	M5	4	19,3	10		10	10
SSC04-G01	4	1/8	5,5	17,3	19	3	13	10
SSC06-M5	6	M5	4	20,6	12		12	10
SSC06-G01	6	1/8	5,5	18,8	12	4	13	10
SSC06-G02	6	1/4	6,5	18,8	12	4	16	10
SSC08-G01	8	1/8	5,5	23,2	14	5	14	10
SSC08-G02	8	1/4	6,5	20,7	14	6	16	10
SSC10-G02	10	1/4	6,5	26,4	17	8	17	10
SSC10-G03	10	3/8	7,5	22,9	17	8	20	5
SSC12-G03	12	3/8	7,5	25,4	20	10	20	5
SSC12-G04	12	1/2	9	25,4	20	10	24	5

ART. SSC Dritto filetto conico maschio
Straight male tapered adaptor

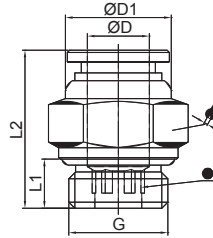
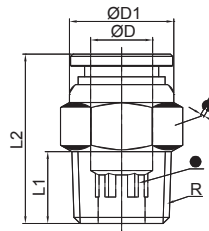

CODICE	ØD	R	L1	L2	ØD1	⊙	↷	📦
SSC04-01	4	1/8	7,5	16,8	10	3	10	10
SSC06-01	6	1/8	7,5	19,3	12	4	12	10
SSC06-02	6	1/4	9,5	19,8	12	4	14	10
SSC08-01	8	1/8	7,5	23,7	14	6	14	10
SSC08-02	8	1/4	9,5	22,2	14	6	14	10
SSC10-02	10	1/4	9,5	26,4	14	8	17	10
SSC10-03	10	3/8	10,5	22,9	17	8	17	5
SSC12-03	12	3/8	10,5	26,4	30	10	20	5
SSC12-04	12	1/2	13,5	26,4	20	10	21	5

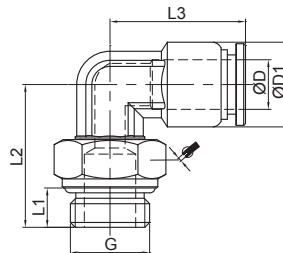

ART. SSL-G Gomito girevole filetto cilindrico maschio
Swivel elbow male parallel adaptor



CODICE	ØD	G	L1	L2	L3	ØD1	↷	📦
SSL04-M5	4	M5	4	17,5	18,3	10	10	10
SSL04-G01	4	1/8	5,5	20	18,3	10	13	10
SSL06-M5	6	M5	4	17,5	20,3	12	10	10
SSL06-G01	6	1/8	5,5	22	20,3	12	13	10
SSL06-G02	6	1/4	6,5	23	20,3	12	16	10
SSL08-G01	8	1/8	5,5	22,5	22,3	14	13	10
SSL08-G02	8	1/4	6,5	23,5	22,3	14	16	5
SSL10-G02	10	1/4	6,5	31	26,4	17	17	5
SSL10-G03	10	3/8	7,5	28,5	26,4	17	20	5
SSL12-G03	12	3/8	7,5	30	29,4	20	20	5
SSL12-G04	12	1/2	9	30,5	29,4	20	24	5



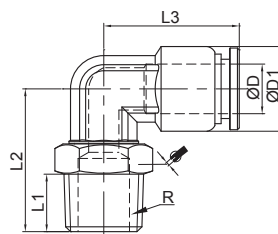

ART. SSL Gomito girevole filetto conico maschio
Swivel elbow male tapered adaptor

CODICE	ØD	R	L1	L2	L3	ØD1		
SSL04-01	4	1/8	7,5	20	18,3	10	12	10
SSL06-01	6	1/8	7,5	23	20,3	12	12	10
SSL06-02	6	1/4	9,5	23	20,3	12	14	10
SSL08-01	8	1/8	7,5	23,5	22,3	14	12	10
SSL08-02	8	1/4	9,5	23,5	22,3	14	14	5
SSL10-02	10	1/4	9,5	33	26,4	17	17	5
SSL10-03	10	3/8	10,5	30	26,4	17	17	5
SSL12-03	12	3/8	10,5	31,5	29,4	20	17	5
SSL12-04	12	1/2	13,5	33,5	29,4	20	21	5

ART. SSB-G T centrale girevole filetto cilindrico
Swivel male stud tee parallel

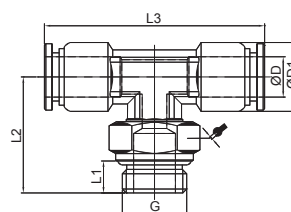
CODICE	ØD	G	L1	L2	L3	ØD1		
SSB04-M5	4	M5	4	17,5	36,6	10	10	10
SSB04-G01	4	1/8	5,5	20	36,6	10	13	10
SSB06-M5	6	M5	4	17,5	40,6	12	10	5
SSB06-G01	6	1/8	5,5	22	40,6	12	13	5
SSB06-G02	6	1/4	6,5	23	40,6	12	16	5
SSB08-G01	8	1/8	5,5	22,5	44,6	14	13	5
SSB08-G02	8	1/4	6,5	23,5	44,6	14	16	5
SSB10-G02	10	1/4	6,5	31	52,8	17	17	5
SSB10-G02	10	3/8	7,5	28,5	52,8	17	20	5
SSB12-G03	12	3/8	7,5	30	58,8	20	20	5
SSB12-G04	12	1/2	9	30,5	58,8	20	24	5

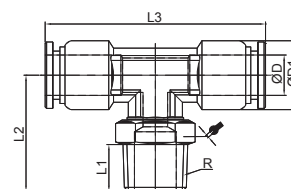

ART. SSB T centrale girevole filetto conico
Swivel male stud tee tapered

CODICE	ØD	R	L1	L2	L3	ØD1		
SSB04-01	4	1/8	7,5	20	36,6	10	12	10
SSB06-01	6	1/8	7,5	23	40,6	12	12	5
SSB06-02	6	1/4	9,5	23	40,6	12	14	5
SSB08-01	8	1/8	7,5	23,5	44,6	14	12	5
SSB08-02	8	1/4	9,5	23,5	44,6	14	14	5
SSB10-02	10	1/4	9,5	33	52,8	17	17	5
SSB10-03	10	3/8	10,5	30	52,8	17	17	5
SSB12-03	12	3/8	10,5	31,5	58,8	20	17	5
SSB12-04	12	1/2	13,5	33,5	58,8	20	21	5

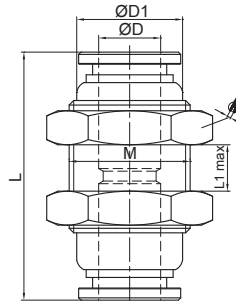

ART. SSM Passaparete innestabile
Bulkhead connector

CODICE	ØD	ØD1	L	L1 max	M		
SSM04	4	10	27	8	M12x1	14	10
SSM06	6	12	29,5	8	M14x1	17	10
SSM08	8	14	32,5	8,5	M16x1	19	5
SSM10	10	17	36,8	9,5	M20x1	24	5
SSM12	12	20	39,8	11,5	M22x1	26	5

ART. SSU Dritto innestabile
Straight connector

CODICE	ØD	ØD1	L	
SSU04	4	11	27	10
SSE06	6	13	29,5	10
SSU08	8	15	32,5	10
SSU10	10	18	36,8	5
SSU12	12	21	39,8	5

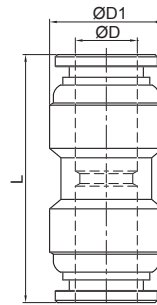
ART. SSV Gomito innestabile
Elbow connector

CODICE	ØD	ØD1	L	
SSV04	4	10	18,3	10
SSV06	6	12	20,3	10
SSV08	8	14	22,3	10
SSV10	10	17	26,4	5
SSV12	12	20	29,4	5

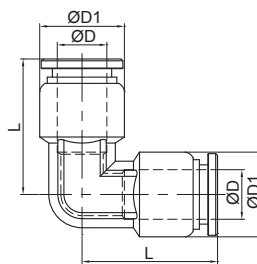
ART. SSE T innestabile
T connector

CODICE	ØD	ØD1	L	L1	
SSE04	4	10	18,3	36,6	10
SSE06	6	12	20,3	40,6	5
SSE08	8	14	22,3	44,6	5
SSE10	10	17	26,4	52,8	5
SSE12	12	20	29,4	58,8	5

