

ART. 01 Dritto filetto cilindrico maschio con O-Ring
Straight male adaptor (parallel)

CODICE	ØD	G	ØC	ØB	H	L			
01CH04M5	4	M5	2,2	11,3	3,5	20	10	2	100
0104M5	4	M5	2,6	9	4	20,5	Ø9	2,5	100
0104M6	4	M6	2,6	9	5	20,5	Ø9	2,5	50
010418	4	1/8	2,6	13,5	5,5	20	9	2,5	50
010414	4	1/4	2,6	17	6,5	21	9	2,5	50
0106M5	6	M5	2,6	11	4	22,8	Ø11	2,5	50
0106M6	6	M6	2,6	11	5	24,8	Ø11	2,5	50
010618	6	1/8	4,2	13,5	5,5	25,3	11	4	50
010614	6	1/4	4,2	17	6,5	24,3	11	4	50
010818	8	1/8	5,2	12,8	5,5	27	13	5	50
010814	8	1/4	6,2	17	6,5	25,5	13	6	50
010838	8	3/8	6,2	20	7,5	25,5	13	6	50
010812	8	1/2	13,0	24	10	24	17	6	25
011018	10	1/8	5,9	9	5,5	29	17	4	25
011014	10	1/4	7,3	16	6,5	30,4	16	7	50
011038	10	3/8	8,3	21	7,5	30,9	16	8	50
011012	10	1/2	14,1	23	10	24,7	17	8	25
011214	12	1/4	7,3	16	6,5	33,2	19	7	25
011238	12	3/8	10,3	22	7,5	33,2	19	10	25
011212	12	1/2	10,3	24	9	33,2	19	10	25
011438	14	3/8	10,3	21	7,5	35	19	10	25
011412	14	1/2	12,3	25	9	35	19	12	25

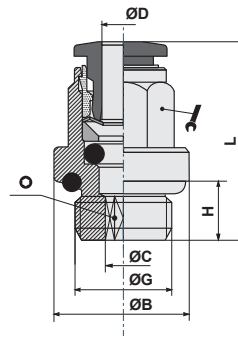
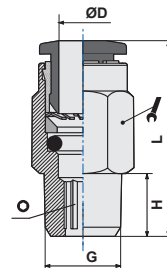

ART. 01C Dritto filetto conico maschio
Straight male adaptor (tapered)

CODICE	ØD	G		H	L			
01C0418	4	1/8		7,5	18	10	2,5	50
01C0414	4	1/4		9,5	16	14	2,5	50
01C0438	4	3/8		7,5	17,4	17	3	25
01C0618	6	1/8		7,5	19,5	12	4	50
01C0614	6	1/4		9,5	22,3	14	4	50
01C0638	6	3/8		10,5	20,3	17	4	25
01C0612	6	1/2		10	23,2	24	4	25
01C0818	8	1/8		7,5	25,5	14	5	50
01C0814	8	1/4		9,5	24,5	14	6	50
01C0838	8	3/8		10,5	21,5	17	6	50
01C0812	8	1/2		12,5	25,5	21	6	25
01C1018	10	1/8		7,5	29,5	17	4	25
01C1014	10	1/4		9,5	30,8	17	7	50
01C1038	10	3/8		10,5	28,3	17	8	50
01C1012	10	1/2		13,5	26,6	21	8	25
01C1218	12	1/8		7	31	21	4	25
01C1214	12	1/4		9,5	33	19	6	25
01C1238	12	3/8		10,5	30	21	10	25
01C1212	12	1/2		13,5	32,5	21	10	25
01C1438	14	3/8		9	37,5	21	10	25
01C1412	14	1/2		14	35	21	10	25

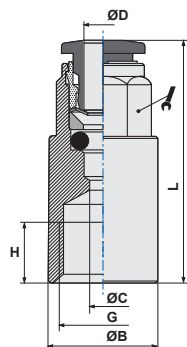

ART. 02 Diritto femmina
Straight female adaptor

CODICE	ØD	G	ØC	ØB	H	L		
020418	4	1/8	3	12	6,5	26,5	9	50
020414	4	1/4	3	17	10	29,5	9	50
020618	6	1/8	5	12	6,5	28,3	11	50
020614	6	1/4	5	17	10	31,3	11	50
020818	8	1/8	7	12	6,5	28,5	13	50
020814	8	1/4	7	17	10	32,5	13	50



ART. 03 Diritto innestabile
Straight connector

CODICE	ØD	ØD1	ØB	ØC	L		
030400	4	4	3	11	32		50
030600	6	6	5	13	36,1		50
030800	8	8	7	15	38		50
031000	10	10	9	18	42,3		50
031200	12	12	11	21	45,8		25
031400	14	14	13	23	48,9		25

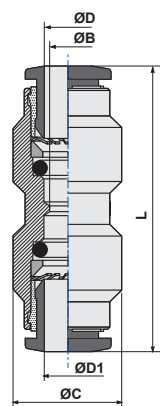

ART. 03F Diritto innestabile filettato
Threaded connector

CODICE	ØD	ØC	M	L		
03F0400	4	3	11x1	32		50
03F0600	6	5	14x1	36,1		50
03F0800	8	7	16x1	38		50
03F1000	10	9	18x1	42,3		50
03F1200	12	11	22x1	45,8		25
03F1400	14	13	24x1	47,5		25

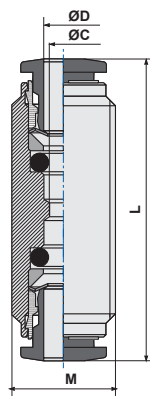

ART. 04 Gomito innestabile
Elbow connector

CODICE	ØD	ØC	ØB	L		
040400	4	3	10	19		50
040600	6	5	11	20,6		50
040800	8	7	13	23		50
041000	10	8	16	26,4		50
041200	12	10	19	28,9		25
041400	14	12	21	31,5		25

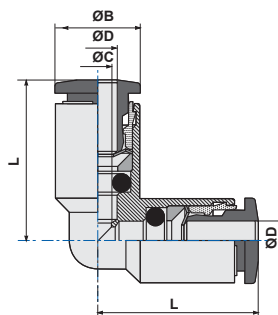

ART. 04L0 Gomito innestabile con codolo
Plug-in elbow connector

CODICE	ØD1	ØD2	L1	L2	L3	
0404L0	4	4	19,5	18	15,5	50
0406L0	6	6	26,5	20	18	50
0408L0	8	8	31	24	19,5	50
0410L0	10	10	41	25	24	25
0412L0	12	12	29	28	25	25

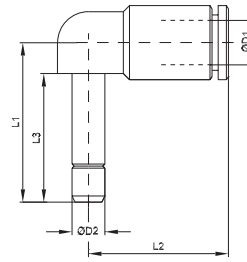
ART. 05 T innestabile
T connector

CODICE	ØD	ØC	ØB	L	
050400	4	3	9	17,3	50
050600	6	5	11	20,6	50
050800	8	7	13	23	50
051000	10	8	16	26,4	25
051200	12	10	19	28,9	25
051400	14	12	21	31,5	10

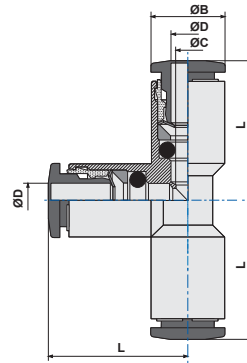

ART. 06 Innesto filetto cilindrico con O-Ring
Adaptor parallel (short)

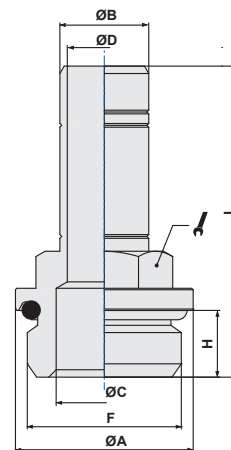
CODICE	ØB	F	ØA	ØC	ØD	H	L		
0604M5	4	M5	8	2	2	4	24,7	8	50
060418	4	1/8	13	5,5	2	5,5	27,7	13	50
060414	4	1/4	16	7,5	2	6,5	29,2	13	50
0604M6	4	M6	9	2	2	5	25,7	8	50
0606M5	6	M5	8	2,6	2,6	4	27,5	8	50
0606M6	6	M6	9	2,6	2,6	5	29,0	8	50
060618	6	1/8	13	5,5	4	5,5	30,5	13	50
060614	6	1/4	16	7,5	4	6,5	33,5	13	50
060818	8	1/8	13	6	6	5,5	32,0	13	50
060814	8	1/4	16	7,5	6	6,5	33,5	13	50
060838	8	3/8	20	9	6	7,5	35,5	13	50
061018	10	1/8	13	6	6	5,5	35,0	13	50
061014	10	1/4	16	8	8	8	38,0	13	50
061038	10	3/8	20	8	8	7,5	39,5	13	50
061214	12	1/4	16	8	8	6,5	37,5	13	25
061238	12	3/8	20	11	10	7,5	40,5	13	25
061212	12	1/2	24	13	10	9	42,0	16	25
061438	14	3/8	20	12	12	7,5	43,0	16	25
061412	14	1/2	24	13	12	9	44,5	16	25



ART. 06F

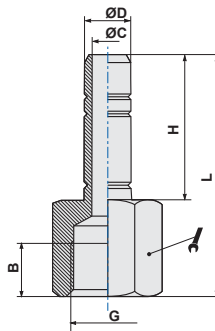

Innesto filetto cilindrico femmina
Female parallel adaptor

CODICE	ØD	G	ØC	B	H	L			
06F0418	4	1/8	2	7	16,7	29,7		12	50
06F0618	6	1/8	4	7	19,5	32,5		12	50
06F0614	6	1/4	4	8	19,5	35,5		17	50
06F0814	8	1/4	6	8	21	37		17	50



ART. 60

Innesto prolungato filetto cilindrico con O-Ring
Adaptor parallel long

CODICE	ØD	G	ØC	ØB	H	L	ØA		
600418	4	1/8	2	13	5,5	39	6	13	50
600618	6	1/8	4	13	5,5	44,5	5,5	13	50
600614	6	1/4	4	16	6,5	48	7,5	13	50
600818	8	1/8	6	13	5,5	48	6	13	50
600814	8	1/4	6	16	6,5	49,5	7,5	13	50
600838	8	3/8	6	20	7,5	51,5	9	13	50
601014	10	1/4	8	16	6,5	54	8	13	50
601038	10	3/8	8	13	7,5	57,5	9	13	25

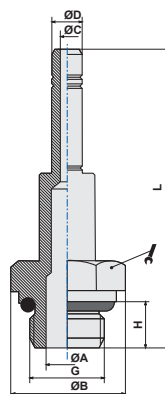

ART. 07

Prolungamento
Connector

CODICE	ØD		ØC		L	
070400	4		2		33,4	100
070600	6		4		39	50
070800	8		6		42	50
071000	10		8		48	50
071200	12		10		50	50

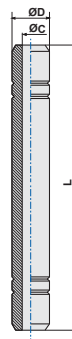

ART. 08

Riduzione con codolo
Plug-in reducer

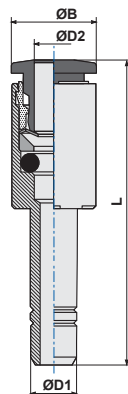

CODICE	ØD1	ØD2		ØB	L	
080604	6	4		9	32,5	50
080804	8	4		9	34	50
080806	8	6		11	36	50
081006	10	6		11	39,3	50
081008	10	8		13	39	50
081208	12	8		13	39,5	25
081210	12	10		16	41,4	25
081406	14	6		15	43,8	25



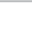

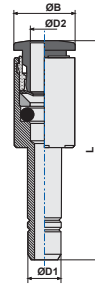
ART. 08/E *Maggiorazione con codolo*
Plug-in increaser

CODICE	ØD1	ØD2		ØB	L		
08E0406	4	6		11	35,5	50	
08E0608	6	8		13	39	50	

ART. 09 *Tappo*
Plug

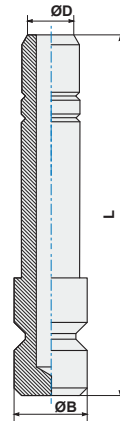

CODICE	ØD	ØB		L		
090400	4	5		26	50	
090600	6	7		29	50	
090800	8	9		31,5	50	

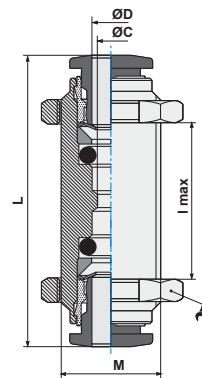

ART. 10 *Passaparete*
Bulkhead connector

CODICE	ØD	ØC	M	I _{max}	L		
100400	4	3	11x1	8	32	14	50
100600	6	5	14x1	8	36,1	17	50
100800	8	7	16x1	10	38	18	50
101000	10	9	18x1	12	42,3	21	25
101200	12	11	22x1	17	45,8	26	25
101400	14	13	24x1	18	47,5	27	25

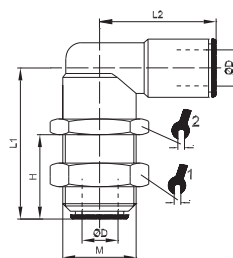

ART. 10L Passaparete ad L
Elbow bulkhead

CODICE	ØD	M	H	L1	L2			
10L0400	4	M10x1	12,5	25,5	20	13	13	50
10L0600	6	M14x1	15	28	21	17	17	50
10L0800	8	M16x1	17	30,5	24	18	18	50
10L1000	10	M17x1	19	35	27	20	20	50

ART. 13 Anello semplice
Single banjo body

CODICE	ØD	G*	ØA	ØB	H	L	
1304M5	4	M5	5	8	9	19,5	50
130418	4	1/8	9,9	14	15	21,1	50
130618	6	1/8	9,9	14	15	24,3	50
130614	6	1/4	13,3	18	17	25,5	50
130818	8	1/8	9,9	14	15	24,8	50
130814	8	1/4	13,3	18	17	26,5	50
130838	8	3/8	16,75	21	20	28,0	50
131014	10	1/4	13,3	18	17	28,4	50
131038	10	3/8	16,75	21	20	29,9	25
131214	12	1/4	13,3	18	17	30,9	25
131238	12	3/8	16,75	21	20	31,4	25
131212	12	1/2	21	26	24	34,9	25
131412	14	1/2	21	26	24	35,5	25

(*) G = filetto vite/asta
(*) G = steam thread

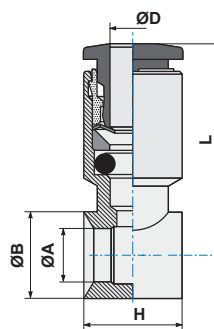
ART. 14 Anello doppio
Double banjo body

CODICE	ØD	G*	ØA	ØB	H	L	
1404M5	4	M5	5	8	9	19,5	50
140418	4	1/8	9,9	14	15	21,1	50
140618	6	1/8	9,9	14	15	24,3	50
140614	6	1/4	13,3	18	17	25,5	50
140818	8	1/8	9,9	14	15	24,8	50
140814	8	1/4	13,3	18	17	26,5	50
140838	8	3/8	16,75	21	20	28	50
141014	10	1/4	13,3	18	17	28,4	50
141038	10	3/8	16,75	21	20	29,9	25

(*) G = filetto vite/asta
(*) G = steam thread

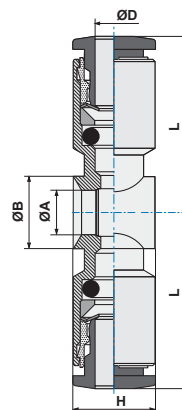

ART. 15 Anello semplice girevole con asta
Complete single banjo (rotating under pressure)

CODICE	ØD	G	ØA	H	L1	L		⊙	▲
1504M5	4	M5	2	4	16,8	19,5		2,5	50
1504M6	4	M6	2	4	17,8	19,5		2,5	50
150418	4	1/8	5,5	5,5	25	21,1		3	50
1506M5	6	M5	2	4	16,5	22		2,5	50
150618	6	1/8	5,5	5,5	24,5	24,3		3	50
150614	6	1/4	7,8	6,5	28	25,5		4	50
150818	8	1/8	5,5	5,5	24,5	24,8		3	50
150814	8	1/4	7,8	6,5	28	26,5		4	50
150838	8	3/8	10	7,5	32,5	28		5	25
151014	10	1/4	7,8	6,5	28	28,4		4	25
151038	10	3/8	10	7,5	32,5	29,9		5	25
151214	12	1/4	7,8	6,5	28	30,9		4	25
151238	12	3/8	10	7,5	32,5	31,4		5	25
151212	12	1/2	12	9	40,8	34,9		8	10
151412	14	1/2	12	9	40,8	35,5		8	10

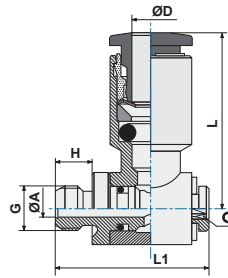

ART. 16 Anello doppio girevole con asta
Complete double banjo (rotating under pressure)

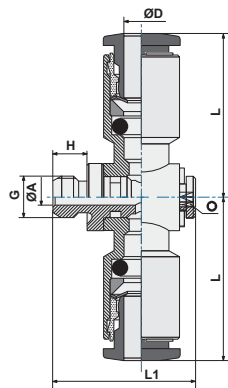
CODICE	ØD	G	ØA	H	L1	L		⊙	▲
1604M5	4	M5	2	4	16,8	19,5		2,5	50
160418	4	1/8	5,5	5,5	24,5	21,1		3	50
160618	6	1/8	5,5	5,5	24,5	24,3		3	50
160614	6	1/4	7,8	6,5	28	25,5		4	50
160818	8	1/8	5,5	5,5	25	24,8		3	50
160814	8	1/4	7,8	6,5	28	26,5		4	25
160838	8	3/8	10	7,5	32,5	28		5	25
161014	10	1/4	7,8	6,5	28	28,4		4	25
161038	10	3/8	10	7,5	32,5	29,9		5	25

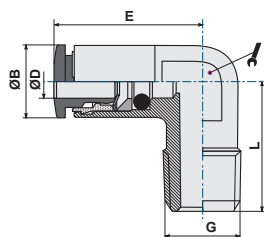

ART. 19 Raccordo ad elle fisso
Elbow male adaptor

CODICE	ØD	G	ØB	E	L		
190418	4	1/8	9	18,6	16,5	10	100
190618	6	1/8	11	23,8	16,5	10	100
190614	6	1/4	11	25,3	22,5	11	100
190818	8	1/8	13	25,5	18,5	11	100
190814	8	1/4	13	25,5	22,0	11	100
191014	10	1/4	16	28,0	24,0	13	50



ART. 20 Raccordo a T centrale girevole
Swivel male stud tee parallel

CODICE	ØD	A	H	ØB	L1	L2		
2004M5	4	M5	4	9	17,3	20,0	8	50
200418	4	1/8	5,5	11,40	17,3	18,5	13	50
200414	4	1/4	6,5	9	19,0	22,5	16	50
2006M5	6	M5	4	11,20	20,5	21	8	50
200618	6	1/8	5,5	11	19,5	18,5	13	50
200614	6	1/4	6,5	11	22,1	22,5	16	50
200818	8	1/8	5,5	13	23,0	20,5	13	50
200814	8	1/4	6,5	13	23,0	22,5	16	50
200838	8	3/8	7,5	13	24,5	25,5	18	25
201014	10	1/4	6,5	16	26,4	24,5	16	25
201038	10	3/8	7,5	16	26,4	25,5	18	25

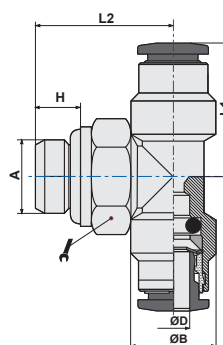

ART. 21 Raccordo a T laterale girevole
Swivel male branch tee parallel

CODICE	ØD	G	H	ØB	L1	L2		
2104M5	4	M5	4	8	16,5	19	9	100
210418	4	G1/8	6	13	18,5	17,5	13	100
210414	4	G1/4	8	16	22,5	19	13	100
210618	6	G1/8	6	13	20	21	13	100
210614	6	G1/4	8	16	24	21	13	100
210818	8	G1/8	6	13	20	23	13	100
210814	8	G1/4	8	16	24	23	13	100
210838	8	G3/8	9	20	25,5	23	13	50
211014	10	G1/4	8	16	24	27	16	50
211038	10	G3/8	9	20	28	27	16	50

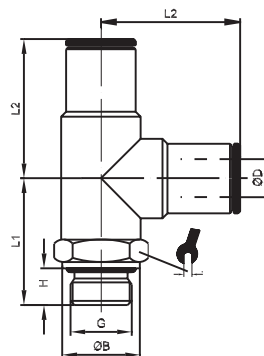

ART. 22 Gomito girevole filetto cilindrico maschio con O-Ring
Swivel elbow male adaptor parallel

CODICE	ØD	A	H	ØB	L1	L2		
2204M5	4	M5	4	9,1	17,3	14,8	9	100
220418	4	1/8	6	9,1	18,0	20,0	13	100
220414	4	1/4	8	9,1	18,0	24,0	13	100
220438	4	3/8	9	9,1	18,0	25,5	13	100
2206M5	6	M5	4	11	14,5	21,0	9	100
220618	6	1/8	6	11	23,0	20,0	13	100
220614	6	1/4	8	11	23,0	24,0	13	100
220638	6	3/8	9	11	23,0	25,5	13	100
220818	8	1/8	6	13	25,5	20,3	13	100
220814	8	1/4	8	13	25,5	24,3	13	100
220838	8	3/8	9	13	25,5	25,8	13	50
221014	10	1/4	8	16	27,0	26,0	16	50
221038	10	3/8	9	16	27,0	27,5	16	50
221012	10	1/2	11	16	27,0	27,5	16	50
221214	12	1/4	8	19	29,0	30,5	16	25
221238	12	3/8	9	19	29,0	28,5	20	25
221212	12	1/2	11	19	29,0	33,5	20	25
221438	14	3/8	9	21	32,0	28,5	20	25
221412	14	1/2	11	21	32,0	33,5	20	25

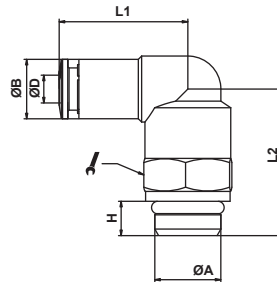
ART. 22L Gomito girevole cilindrico lungo
Swivel longer elbow male adaptor parallel

CODICE	ØD	G	ØB	H	L1	L2		
22L04M5	4	M5	8	4	23,5	18	9	25
22L0418	4	G1/8	13	6	33	20	13	25
22L0414	4	G1/4	16	8	38	20	13	25
22L06M5	6	M5	8	4	23,5	21	9	25
22L0618	6	G1/8	13	6	33	21	13	25
22L0614	6	G1/4	16	8	38	21	13	25
22L0818	8	G1/8	13	6	33	24	13	10
22L0814	8	G1/4	16	8	38	24	13	10
22L0838	8	G3/8	20	7	34,5	21	20	10
22L1014	10	G1/4	16	6,5	37	26,5	16	10
22L1038	10	G3/8	20	7	38	26,5	20	10

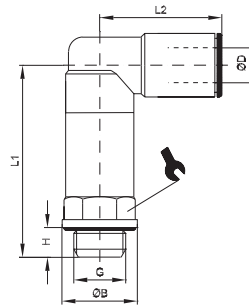

ART. 25 Passaparete femmina
Female bulkhead

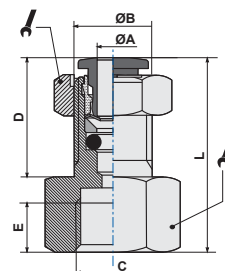
CODICE	ØA	C	ØB	D	E	L		
250418	4	1/8	M12x1	15,5	8,5	24,0	14	25
250618	6	1/8	M14x1	15,8	8,5	26,8	15	25
250614	6	1/4	M14x1	15,8	11,0	29,5	17	25
250818	8	1/8	M16x1	16,0	8,5	26,5	19	25
250814	8	1/4	M16x1	16,0	11,0	32,0	19	25

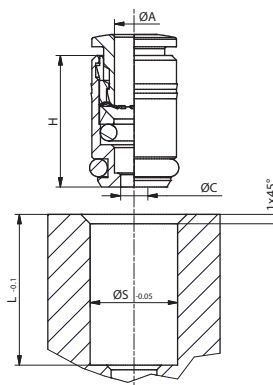

ART. 27 Cartuccia
Cartridge

CODICE	ØD	ØC	H	ØS	L		
270400	4	2,9	14	9,1	13,5		100
270600	6	5	16	11,1	15,5		50
270800	8	7	17	13,6	16,5		50



ART. 33 Doppio anello semplice girevole con asta
Swivel double banjo stem

CODICE	ØD	G	ØA	H	L1	L			
330418	4	1/8	5,5	5,5	43,8	21,1	14	3	25
330618	6	1/8	5,5	5,5	43,8	24,3	14	3	25
330818	8	1/8	5,5	5,5	43,8	24,8	14	3	25
330614	6	1/4	7,8	7,5	51,5	25,5	18	4	25
330814	8	1/4	7,8	7,5	51,5	26,5	18	4	25
331014	10	1/4	7,8	7,5	51,5	28,4	18	4	25

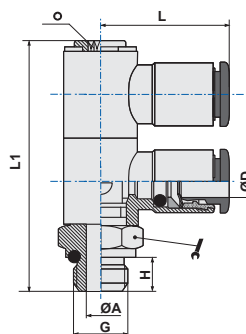

ART. 34 Triplo anello semplice girevole con asta
Swivel triple banjo stem

CODICE	ØD	G	ØA	H	L1	L			
340418	4	1/8	5,5	5,5	58,4	21,1	14	3	10
340618	6	1/8	5,5	5,5	58,4	24,3	14	3	10
340818	8	1/8	5,5	5,5	58,4	24,8	14	3	10
340614	6	1/4	7,8	7,5	67	25,5	18	4	10
340814	8	1/4	7,8	7,5	67	26,5	18	4	10
341014	10	1/4	7,8	7,5	67	51,5	18	4	10

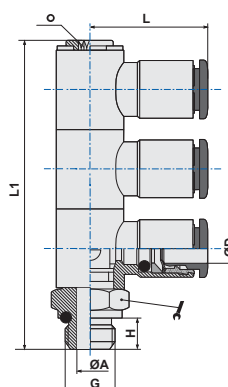

ART. RDR

 Diritto filetto cilindrico maschio con O-Ring
Straight male adaptor (parallel)

CODICE	D	G	C	H	L		⊘	▶
RDR1.33 FH	3,25	M6	6,5	11	20,3		2	100
RDR3.20	2,0	M3	5,4	3	13,5		1,5	100
RDR3.30	3,0	M3	5,8	3	14,5		1,5	100
RDR3.31	3,17	M3	5,8	3	14,0		1,5	100
RDR3.40	4,0	M3	7,0	3	15,5		1,5	100
RDR3.40-MH05	4,0	M3	6,9	5	17,5		1,5	100
RDR5.20	2,0	M5	5,4	3,5	13,0		1,5	100
RDR5.30	3,0	M5	5,8	3,5	14,5		2,0	100
RDR5.31	3,17	M5	5,8	3,5	14,5		2,0	100
RDR5.40	4,0	M5	5,8	3,5	16,5		2,0	100
RDR6.40-FH12	4,0	M6	7	12	24,5		2,0	100
RDR6.40-MH12	4,0	M6	7	12	24,5		2,0	100

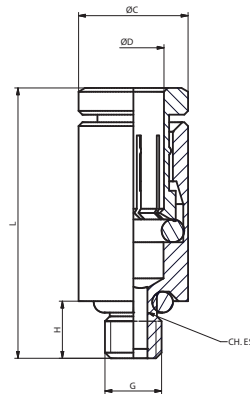
ART. RGR

 Asta con filetto cilindrico in anello semplice
Complete single banjo with stem

CODICE	D	G	C	H	L	L1	⊘	▶
RGR3.20	2	M3	1,4	3,0	13,5	13,5	1,5	100
RGR3.30	3	M3	1,4	3,0	13,5	13,5	1,5	100
RGR3.31	3,17	M3	1,4	3,0	13,5	13,5	1,5	100
RGR3.40	4,2	M3	1,4	3,0	13,5	13,5	1,5	100
RGR3.40-MH05	4,2	M3	1,4	5,0	13,5	13,5	1,5	100
RGR5.20	2	M5	2,0	3,5	14	14	2,0	100
RGR5.30	3	M5	2,0	3,5	14	14	2,0	100
RGR5.31	3,2	M5	2,0	3,5	13,5	13,5	2,0	100
RGR5.40	4,2	M5	2,0	3,5	13,5	13,5	2,0	100
RGR6.40-FH12	4,2	M6	2,0	12	13,5	13,5	2,0	100
RGR6.40-MH12	4,0	M6	2,0	12	13,5	13,5	2,0	100

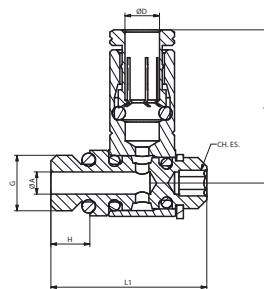
ART. RDSR

 Diritto maschio cilindrico con scarico rapido
Quick exhaust straight male parallel adapter

CODICE	L	ØC	ØD	G	H		⊘	▶
RDSR520	18,5	6,8	2,0	M5	3,5		7	100
RDSR530	18,5	6,8	3,0	M5	3,5		7	100
RDSR531	18,3	6,8	3,0	M5	3,5		7	100
RDSR540	19,5	7,8	4,2	M5	3,5		8	100

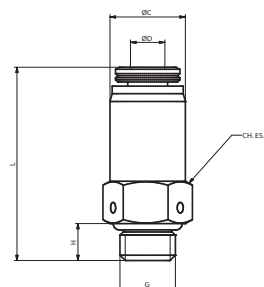

ART. **RGSR**

Gomito girevole cilindrico con scarico rapido
Quick exhaust swivel elbow parallel adapter

CODICE	ØB	ØD	H	H2	E	G	●	🏭
RGSR520	5,8	2,1	3,5	19	14	M5	7	100
RGSR530	5,8	3,0	3,5	19	14	M5	7	100
RGSR531	5,8	3,2	3,5	19	14	M5	7	100
RGSR540	5,8	4,2	3,5	19	14	M5	7	100

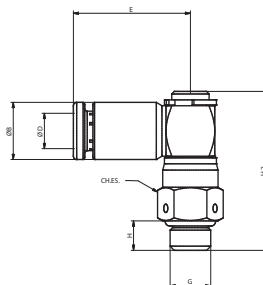

ART. **RRR**

Riduzione con codolo
Plug-in reducer

CODICE	ØD1	ØD2	ØB	L	🏭
RRR3020 *	2,0	3,2	5,8	23,2	100
RRR4020	4,0	4,0	5,8	25,5	100
RRR4030	4,0	4,0	5,8	25,5	100

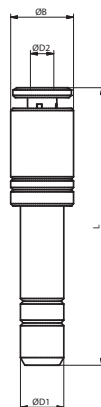



ART. **RTR**

T combinato filettato e intermedio
T combined thread and connector

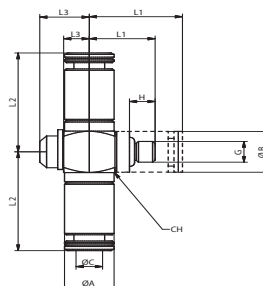

CODICE	L1	L2	G	H	ØB	ØA	ØC	L3	●	🏭
RTR020	13,7	12			5,8	5,8	2,10	3	6	100
RTR330	7,7	14	M3	3	5,8	5,8	3,0	5,8	6	100



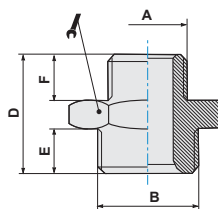

ART. 101 Nipplo cilindrico
Parallel nipple

CODICE	A	B	D	E	F		
101M5M5	M5	M5	11,5	4	4	8	100
101M518	M5	G1/8	14,5	6	4	14	100
1011818	G1/8	G1/8	16,5	6	6	14	100
1011814	G1/8	G1/4	19,0	8	6	17	100
1011838	G1/8	G3/8	20,0	9	6	19	100
1011414	G1/4	G1/4	21,0	8	8	17	100
1011438	G1/4	G3/8	22,0	9	8	19	100
1011412	G1/4	G1/2	23,5	10	8	24	100
1013838	G3/8	G3/8	23,0	9	9	19	100
1013812	G3/8	G1/2	24,5	10	9	24	50
1011212	G1/2	G1/2	25,5	10	10	24	50
1013434	G3/4	G3/4	28,5	11	11	30	25
1011234	G1/2	G3/4	27,5	11	10	30	25

ART. 102 Nipplo conico
Taper nipple

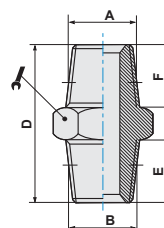
CODICE	A	B	D	E	F		
1021818	G1/8	G1/8	20,0	8,0	8,0	12	100
1021814	G1/8	G1/4	24,0	11,0	8,0	14	100
1021838	G1/8	G3/8	24,5	11,5	8,0	17	100
1021812	G1/8	G1/2	27,5	14,0	8,0	22	50
1021414	G1/4	G1/4	27,0	11,0	11,0	14	100
1021438	G1/4	G3/8	27,5	11,5	11,0	17	100
1021412	G1/4	G1/2	30,5	14,0	11,0	22	50
1023838	G3/8	G3/8	28,0	11,5	11,5	17	100
1023812	G3/8	G1/2	31,0	14,0	11,5	22	50
1021212	G1/2	G1/2	33,5	14,0	14,0	22	50
1021234	G1/2	G3/4	37,5	16,5	14,0	27	25
1023434	G3/4	G3/4	40,0	16,5	16,5	27	25
1023401	G3/4	G1'	42,5	19,0	16,5	34	10
1020101	G1'	G1'	45,0	19,0	19,0	34	10

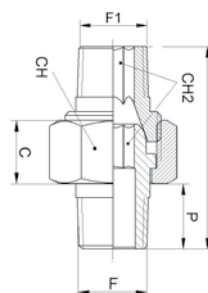

ART. 102P3 Nipplo conico 3 pezzi
Nipple (taper) - 3 pieces

CODICE	F	F1	CH	CH2	P	L	C	Gr	
10218P3	1/8	1/8	15	5	9,0	27,0	8,6	18,5	100
10214P3	1/4	1/4	19	6	11,5	33,5	9,6	36,0	100
10238P3	3/8	3/8	22	8	13,0	36,0	10,0	66,0	100
10212P3	1/2	1/2	27	12	15,5	45,0	12,0	88,0	100
10234P3	3/4	3/4	36	14	18,0	53,0	17,0	200,0	100
10201P3	1"	1"	46	19	22,0	64,0	20,0	360,0	100
1021814P3	1/8	1/4	15	5	9,0	30,0	8,5	24,0	100
1021438P3	1/4	3/8	19	6	11,5	36,0	9,5	45,5	100
1023812P3	3/8	1/2	22	8	13,0	39,0	10,0	76,0	100

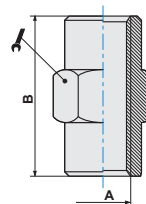

ART. 103 Manicotto filettato
Sleeve

CODICE	A	B					
103M5	M5	11				8	100
10318	G1/8	15				14	100
10314	G1/4	22				17	100
10338	G3/8	23				22	50
10312	G1/2	30				26	25
10334	G3/4	32				32	20

ART. 104 Riduzione M/F conica
Taper reducer

CODICE	A	B	C	D			
1041418	G1/4	G1/8	11,0	16,0		14	100
1043818	G3/8	G1/8	11,5	16,5		17	100
1041218	G1/2	G1/8	14,0	19,5		22	50
1043814	G3/8	G1/4	11,5	16,5		17	100
1041214	G1/2	G1/4	14,0	19,5		22	50
1041238	G1/2	G3/8	14,0	19,5		22	50
1043412	G3/4	G1/2	16,5	23,5		27	25
1043438	G3/4	G3/8	16,5	23,5		27	10
1040112	G1'	G1/2	17,0	25,0		34	10
1040134	G1'	G3/4	17,0	25,0		34	10

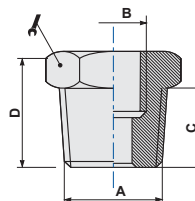

ART. 104Z Riduzione M/F cilindrica
Parallel reducer

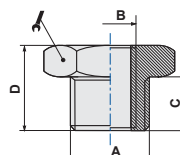
CODICE	A	B	C	D			
104Z18M5	G1/8	M5	6,0	10,5		14	100
104Z1418	G1/4	G1/8	8,0	13,0		17	100
104Z3818	G3/8	G1/8	9,0	14,0		19	100
104Z3814	G3/8	G1/4	9,0	14,0		19	100
104Z1218	G1/2	G1/8	10,0	15,5		24	50
104Z1214	G1/2	G1/4	10,0	15,5		24	50
104Z1238	G1/2	G3/8	10,0	15,5		24	50
104Z3412	G3/4	G1/2	12,5	18,0		30	10
104Z3438	G3/4	G3/8	12,5	18,0		30	10

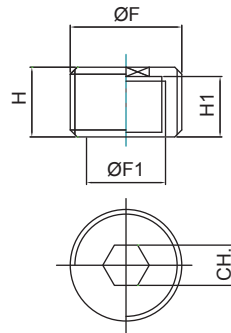

ART. 104S Riduzione cilindrica a scomparsa
Disapperance parallel reducer

CODICE	F	F1	H		
104S1418	1/4	1/8	8		100
104S3814	3/8	1/4	9		100
104S1238	1/2	3/8	10		100
104S3412	3/4	1/2	14		100
104S0134	1"	3/4	20		100

ART. 105 Prolunga M/F conica
Taper M/F extension

CODICE	A	B	C	D	E		
1051818	G1/8	G1/8	8,0	18,0	8,0	14	100
1051814	G1/8	G1/4	8,0	21,5	11,0	17	100
1051838	G1/8	G3/8	8,0	22,5	11,5	22	50
1051414	G1/4	G1/4	11,0	24,5	11,0	17	100
1051438	G1/4	G3/8	11,0	24,5	11,5	22	50
1051412	G1/4	G1/2	11,0	29,0	14,0	24	50
1053838	G3/8	G3/8	11,5	26,0	11,5	22	50
1053812	G3/8	G1/2	11,5	29,5	14,0	24	25
1051212	G1/2	G1/2	14,0	32,0	14,0	26	25
1051234	G1/2	G3/4	14,0	35,0	16,5	32	10
1051201	G1/2	G1	14,0	37,0	18,0	38	10

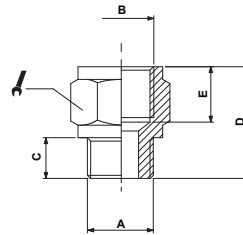

ART. 105Z Prolunga M/F cilindrica
Parallel M/F extension

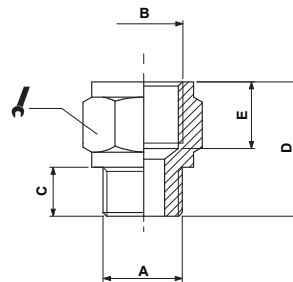
CODICE	A	B	C	D	E		
105ZM5M5	M5	M5	5	14,0	7,0	9	100
105ZM518	M5	G1/8	4	14,5	8,0	14	100
105ZM618	M6	G1/8	6	16,0	8,0	14	100
105Z1818	G1/8	G1/8	6	16,0	8,0	14	100
105Z1814	G1/8	G1/4	6	19,5	11,0	17	100
105Z1838	G1/8	G3/8	6	20,5	11,5	22	50
105Z1414	G1/4	G1/4	8	21,5	11,0	17	100
105Z1438	G1/4	G3/8	8	22,5	11,5	22	50
105Z1412	G1/4	G1/2	8	26,0	14,0	24	50
105Z3838	G3/8	G3/8	9	23,5	11,5	22	50
105Z3812	G3/8	G1/2	9	27,0	14,0	24	25
105Z1212	G1/2	G1/2	10	28,0	14,0	26	25
105Z1234	G1/2	G3/4	10	30,0	16,5	32	10

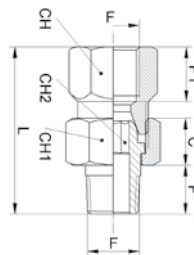

ART. 105P3 Prolunga M/F - 3 pezzi
Extension M/F - 3 pieces

CODICE	F	CH	CH1	CH2	P	P1	L	C	Gr	
10518P3	1/8	14	15	5	9,0	10,0	30,5	8,5	19,0	100
10514P3	1/4	17	19	6	12,0	12,0	37,0	9,5	39,0	100
10538P3	3/8	21	22	8	12,0	12,0	40,0	10,0	68,0	100
10512P3	1/2	25	27	12	15,0	15,0	48,0	12,0	118,0	100

ART. 106 Manicotto riduzione
Reducing sleeve

CODICE	A	B	C		
106M518	M5	G1/8	13,5	14	100
1061814	G1/8	G1/4	19,0	17	100
1061838	G1/8	G3/8	20,0	22	25
1061812	G1/8	G1/2	24,0	26	50
1061438	G1/4	G3/8	23,0	22	50
1061412	G1/4	G1/2	25,0	26	50
1063812	G3/8	G1/2	27,5	26	25
1061234	G1/2	G3/4	30,0	32	20

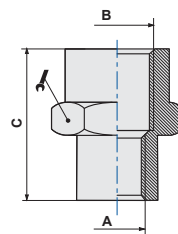
ART. 107 Tappo maschio cilindrico con O-Ring
Parallel male plug + O-Ring

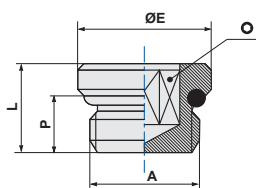

CODICE	A	P	L	ØE		
107M5	M5	4,0	5,5	8	2,5	100
10718	G1/8	6,0	8,0	14	4,0	100
10714	G1/4	8,0	10,0	17	6,0	100
10738	G3/8	9,0	12,0	20	8,0	100
10712	G1/2	11,0	14,0	24	10,0	50
10734	G3/4	15,5	20,0	32	12,0	25

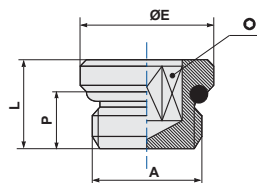

ART. 107P Tappo maschio cilindrico con OR (Tecnopolimero)
Parallel male plug + OR (Technopolymer)



CODICE	A	P	L	ØE		
107P18	G1/8	5,3	8,2	14	4	100
107P14	G1/4	6,5	9,2	18	6	100



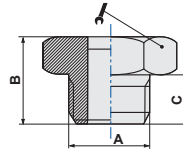

ART. 107Z Tappo maschio cilindrico
Parallel male plug

CODICE	A	B	C				
107Z18	G1/8	10,5	6			14	100
107Z14	G1/4	13,0	8			17	100
107Z38	G3/8	14,0	9			19	50
107Z12	G1/2	15,5	10			24	50
107Z34	G3/4	16,5	11			30	25
107Z01	G1"	19,0	13			38	10

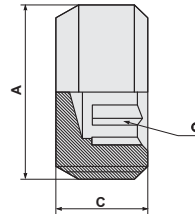

ART. E100 Tappo a scomparsa conico
Disappearance tapered plug

CODICE	A	C			
E10018	G1/8	8		5	100
E10018L5	G1/8	5		5	100
E10014	G1/4	10		6	100
E10038	G3/8	11		8	50
E10012	G1/2	13		10	50

ART. E200 Tappo a scomparsa cilindrico
Disappearance parallel plug

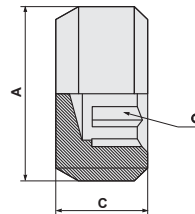
CODICE	A	C			
E20018	G1/8	8		5	100
E20014	G1/4	10		6	100
E20038	G3/8	11		8	50
E20012	G1/2	13		10	50

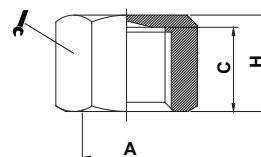

ART. 108 Tappo femmina
Female plug

CODICE	A	C	H			
10818	G1/8	8,0	10,0		14	100
10814	G1/4	11,0	13,5		17	100
10838	G3/8	11,5	14,0		20	50
10812	G1/2	14,0	16,5		24	50

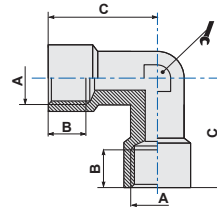

ART. 109 Elle F.F.
Female elbow

CODICE	A	B	C				
10918	G1/8	7	20,0			10	100
10914	G1/4	8	25,5			13	50
10938	G3/8	10	29,0			17	25
10912	G1/2	11	35,0			20	20
10934	G3/4	16	36,0			25	5
10901	G1/2	19	44,0			30	5

ART. 110 Elle M.F.
Male-Female elbow

CODICE	A	A1	B	B1	C	D		
110M5	M5	M5	4		11,0	11,5	9	100
11018	G1/8	G1/8	7	8	20,0	19,0	10	50
11014	G1/4	G1/4	8	11	25,5	24,0	13	50
11038	G3/8	G3/8	10	11,5	29,0	26,5	17	25
11012	G1/2	G1/2	11	14	35,0	31,5	20	20
11034	G3/4	G3/4	16	16	35,0	34,5	25	5
11001	G1'	G1'	19	16	44,0	51,0	30	5
11014F18M	G1/8	G1/4	8	8	25,5	23,0	13	50

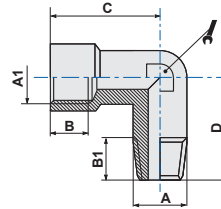
ART. 111 T F.F.F.
Female tee

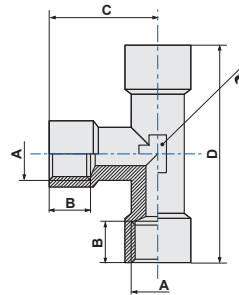

CODICE	A	B	C	D		
11118	G1/8	7	20,0	40	10	50
11114	G1/4	8	25,5	51	13	25
11138	G3/8	10	29,0	58	17	20
11112	G1/2	11	35,0	70	20	10
11134	G3/4	16	31,0	73	25	5
11101	G1'	19	49,5	90	30	5

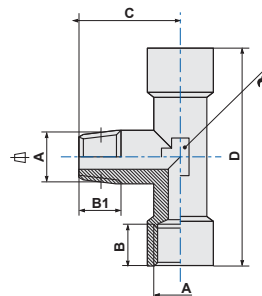

ART. 112 T F.M.F.
Centre male tee



CODICE	A	B	B1	C	D		
11218	G1/8	7	8,0	19,0	40	10	50
11214	G1/4	8	11,0	24,0	51	13	25
11238	G3/8	10	13,6	26,5	58	17	25
11212	G1/2	11	15,5	31,5	72	20	10
11234	G3/4	16	15,0	31,0	73	25	5
11201	G1'	19	16,0	38,0	90	30	5



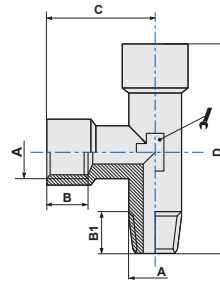

ART. 113 T M.F.F.
Off-set male tee

CODICE	A	B	B1	C	D		
11318	G1/8	7	8,0	20,0	39,0	10	50
11314	G1/4	8	11,0	25,5	49,5	13	25
11338	G3/8	10	13,6	29,0	55,5	17	25
11312	G1/2	11	15,5	35,0	65,0	20	10
11334	G3/4	16	15,0	31,0	67,0	25	5
11301	G1"	19	16,0	44,0	84,0	30	5

ART. 114 Croce F.F.F.F.
Female cross

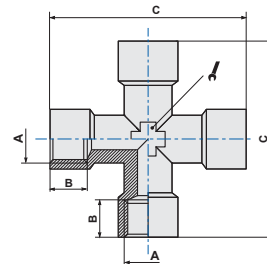
CODICE	A	B	C				
11418	G1/8	7	40			10	25
11414	G1/4	8	51			13	25
11438	G3/8	10	58			17	10
11412	G1/2	11	72			20	5

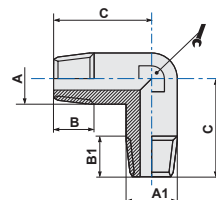

ART. 115 Elle M.M.
Male elbow

CODICE	A	B	C	A1	B1		
11518	G1/8	8,0	19,0	G1/8	8,0	10	100
11514	G1/4	12,5	24,0	G1/4	12,5	13	50
11538	G3/8	13,6	26,5	G3/8	26,5	17	25
11512	G1/2	15,5	31,5	G1/2	15,5	20	25
11534	G3/4	15,0	35,5	G3/4	15,0	25	5
11501	G1"	16,0	51,0	G1"	51,0	30	5
1151814	G1/8	8,0	22,0	G1/4	12,5	13	100

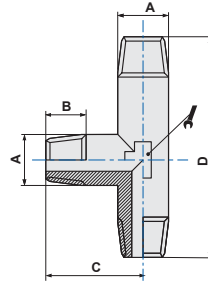

ART. 116 T.M.M.
Male tee

CODICE	A	B	C	D			
11618	G1/8	8,0	19,0	38		10	100
11614	G1/4	12,5	24,0	48		13	50
11638	G3/8	13,6	26,5	53		17	25
11612	G1/2	15,5	31,5	63		20	10
11634	G3/4	15,0	35,5	66		25	5
11601	G1"	16,0	40,5	78		30	5

ART. 117 T.M.F.M.
Centre female tee

CODICE	A	B	B1	C	D			
11718	G1/8	7	8,0	20,0	38		10	100
11714	G1/4	8	12,5	25,5	48		13	50
11738	G3/8	10	13,6	29,0	53		17	25
11712	G1/2	11	15,5	36,0	63		17	10
11734	G3/4	16	15,0	34,5	66		25	5
11701	G1"	19	16,0	46,5	78		30	5

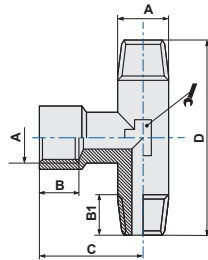
ART. 118 T.M.M.F.
Off-set female tee

CODICE	A	B	C	D			
11818	G1/8	8,0	19,0	39,0		10	100
11814	G1/4	12,5	24,0	49,5		13	50
11838	G3/8	13,6	26,5	55,5		17	25
11812	G1/2	15,5	31,5	67,5		20	10
11834	G3/4	15,0	34,5	69,0		25	5
11801	G1"	16,0	38,0	84,0		30	5

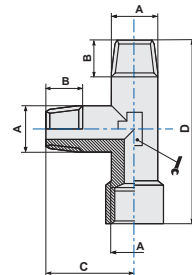

ART. 119

Portagomma maschio con O-Ring
Male hose adapter + O-Ring

CODICE	ØD	A	I	H		
1190718	7	G1/8	6	31,5	13	100
1190714	7	G1/4	8	34,0	16	100
1190818	8	G1/8	6	31,5	13	100
1190918	9	G1/8	6	31,5	13	100
1190914	9	G1/4	8	34,0	16	100
1190938	9	G3/8	9	35,0	17	50
1191018	10	G1/8	6	31,5	13	50
1191014	10	G1/4	8	34,0	16	50
1191038	10	G3/8	9	35,0	17	50
1191214	12	G1/4	8	34,0	16	50
1191238	12	G3/8	9	36,0	17	50
1191212	12	G1/2	11	37,0	22	50
1191738	17	G3/8	9	36,0	17	50
1191712	17	G1/2	11	37,0	22	50

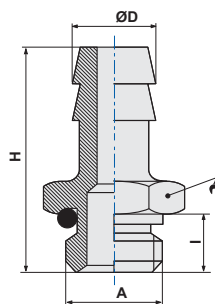

ART. 119Z

Portagomma maschio cilindrico
Male hose adapter

CODICE	ØD	A	I	H	H1		
119Z0618	6	G1/8	6	29,5	19,0	12	100
119Z0614	6	G1/4	8	32,0	19,0	14	100
119Z0718	7	G1/8	6	29,5	19,0	12	100
119Z0714	7	G1/4	8	32,0	19,0	14	100
119Z0818	8	G1/8	6	29,5	19,0	12	100
119Z0814	8	G1/4	8	32,0	19,0	14	100
119Z0838	8	G3/8	9	33,0	19,0	19	100
119Z0918	9	G1/8	6	29,5	19,0	12	100
119Z0914	9	G1/4	8	32,0	19,0	14	100
119Z0938	9	G3/8	9	33,0	19,0	19	100
119Z0912	9	G1/2	10	35,5	19,0	24	25
119Z1018	10	G1/8	6	30,5	20,0	20	100
119Z1014	10	G1/4	8	33,0	20,0	20	50
119Z1038	10	G3/8	9	34,0	20,0	19	100
119Z1012	10	G1/2	10	36,0	20,0	24	50
119Z1214	12	G1/4	8	33,0	20,0	14	50
119Z1238	12	G3/8	9	34,0	20,0	19	50
119Z1212	12	G1/2	10	35,5	20,0	22	50
119Z1438	14	G3/8	9	36,0	22,0	19	50
119Z1412	14	G1/2	10	37,5	22,0	22	50
119Z1638	16	G3/8	9	38,0	24,0	19	50
119Z1612	16	G1/2	10	38,0	22,0	24	25
119Z1738	17	G3/8	9	38,0	24,0	24	50
119Z1712	17	G1/2	10	39,5	24,0	24	50
119Z2012	20	G1/2	10	39,5	24,0	24	25

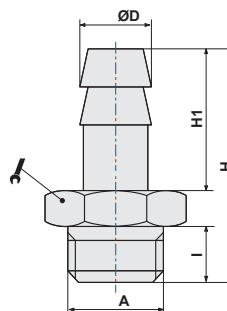

ART. 120 Croce M.F.F.F.
 1 male 3 female cross

CODICE	A	B	B1	C	D		
12018	G1/8	7	8,0	19,0	40	10	25
12014	G1/4	8	12,5	24,0	51	13	25
12038	G3/8	10	13,6	26,5	58	17	10
12012	G1/2	11	15,5	31,5	72	20	5

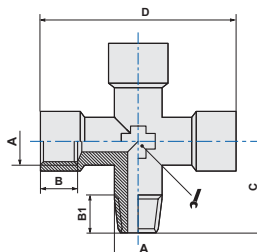
ART. 122 Portagomma femmina
 Female hose adapter

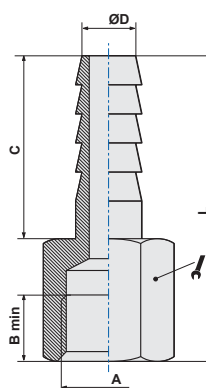

CODICE	ØD	A	B	C	L		
1220618	6	G1/8	7	19	32,0	12	100
1220718	7	G1/8	7	19	32,0	12	100
1220714	7	G1/4	8	19	35,0	17	100
1220814	8	G1/4	8	19	35,0	17	100
1220914	9	G1/4	8	19	35,0	17	100
1221038	10	G3/8	10	19	37,0	20	25
1221238	12	G3/8	10	19	37,0	20	25
1221212	12	G1/2	11	19	40,5	24	10

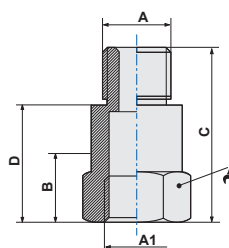

ART. 123 Prolunga
 Extension



CODICE	A	A1	B	C	D		
12318L22	G1/8	G1/8	6	22	15,82	14	100
12318L32	G1/8	G1/8	6	32	25,50	14	100
12318L42	G1/8	G1/8	6	42	36,28	14	100
12318L51	G1/8	G1/8	6	51	45,22	14	50
12314L28	G1/4	G1/4	8	28	20,43	17	100
12314L35	G1/4	G1/4	8	35	27,02	17	50
12314L51	G1/4	G1/4	8	51	43,20	17	25



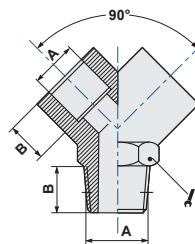



ART. 125 Y maschio
Male Y

CODICE	A	B				
12518	G1/8	8,0			13	50
12514	G1/4	11,0			17	25
12538	G3/8	11,5			20	25
12512	G1/2	14,0			25	10

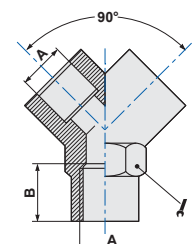

ART. 126 Y femmina
Female Y

CODICE	A	B				
12618	G1/8	8			13	50
12614	G1/4	11			17	25
12638	G3/8	11			20	25
12612	G1/2	14			25	10

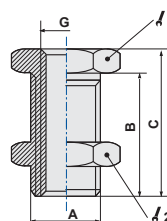

ART. 127 Passaparete femmina (nichelato)
Female bulkhead (nickel plated)

CODICE	G	A	B	C			
127M5	M5	M10x1,0	10,5	14	14	14	100
12718	G1/8	M16x1,5	14,0	18	22	19	50
12714	G1/4	M20x1,5	21,0	24	27	24	25
12738	G3/8	M26x1,5	21,0	26	32	30	25
12712	G1/2	M28x1,5	27,0	33	36	32	10

ART. RLB100 Raccordo ad "L" M/F conico
Male-female elbow tapered

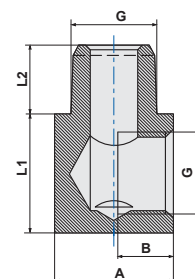
CODICE	G	A	B	L1	L2	
RLB100M5	M5	9	4,5	9	4,5	100
RLB10018	1/8	14	6,5	14	8	100
RLB10014	1/4	17	9	17	9,5	100



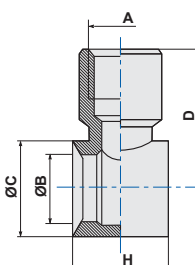

ART. 412 Anello singolo femmina
Female single banjo body

CODICE	A	ØB	ØC	D	H	
41218	G1/8	9,9	14	20	15	50
41214	G1/4	13,3	18	24	17	50
41238	G3/8	16,8	21	28,5	20	25
41212	G1/2	21	26	34,5	24	25



ART. 201

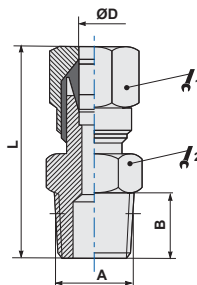

Raccordo diritto maschio conico
Taper straight male adaptor

CODICE	ØD	A	B	L			
2010418	4	G1/8	8,0	27,0	10	11	100
2010618	6	G1/8	8,0	28,0	12	11	100
2010614	6	G1/4	11,0	31,5	12	14	100
2010818	8	G1/8	8,0	29,5	14	12	100
2010814	8	G1/4	11,0	33,0	14	14	100
2010838	8	G3/8	11,0	34,0	14	17	50
2011014	10	G1/4	11,0	33,0	19	17	50
2011038	10	G3/8	11,5	38,0	19	17	50
2011012	10	G1/2	14,0	36,5	19	22	25
2011238	12	G3/8	11,5	33,5	22	19	25
2011212	12	G1/2	14,0	36,5	22	22	25
2011412	14	G1/2	14,0	40,0	22	22	25
2011512	15	G1/2	14,0	41,0	24	22	25
2011612	16	G1/2	14,0	45,0	30	24	10
2011812	18	G1/2	14,0	45,0	32	26	10



ART. 201Z

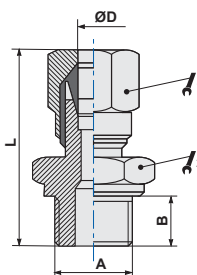

Raccordo diritto maschio cilindrico
Parallel straight male adaptor

CODICE	ØD	A	B	L			
201Z0418	4	G1/8	6	25,0	10	14	100
201Z0618	6	G1/8	6	26,0	12	14	100
201Z0818	8	G1/8	6	27,5	14	14	100
201Z0814	8	G1/4	8	30,0	14	17	50
201Z1014	10	G1/4	8	34,5	19	17	50



ART. 202

Raccordo diritto femmina
Female straight adaptor

CODICE	ØD	A	B	H1	L			
2020418	4	G1/8	8,0	10	24,5	10	14	100
2020618	6	G1/8	8,0	10	26,0	12	14	100
2020614	6	G1/4	11,0	14	30,5	12	17	100
2020818	8	G1/8	8,0	10	26,5	14	14	50
2020814	8	G1/4	11,0	14	31,0	14	17	50
2020838	8	G3/8	11,5	14,5	31,0	14	20	50
2021014	10	G1/4	11,0	14	35,5	19	17	50
2021038	10	G3/8	11,5	14,5	36,5	19	20	25

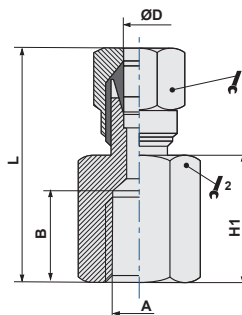

ART. 203
Raccordo diritto intermedio
Straight connector

CODICE	ØD	L					
2030400	4	35,0			10	10	50
2030600	6	36,5			12	12	50
2030800	8	38,5			12	12	50
2031000	10	47,5			19	17	25
2031200	12	50,5			22	19	25
2031400	14	55,5			27	24	10
2031500	15	55,5			27	24	10

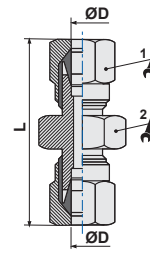
ART. 204
Raccordo passaparete
Bulkhead adaptor

CODICE	ØD	L					
2040600	6	48,0			12	14	50
2040800	8	55,0			14	17	50
2041000	10	58,0			19	19	25
2041200	12	66,0			19	19	10
2041500	15	69,5			27	25	5

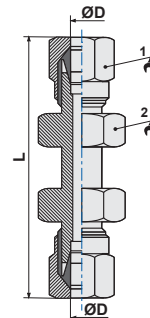

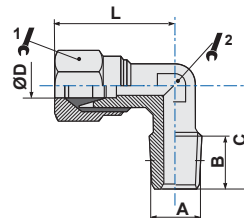

ART. 205
Raccordo ad L
Elbow male adaptor

CODICE	ØD	A	B	C	L				
2050418	4	G1/8	7,5	16,0	21,0		10	9	100
2050618	6	G1/8	7,5	16,0	23,0		12	10	100
2050614	6	G1/4	11,0	20,0	24,5		12	11	100
2050818	8	G1/8	7,5	17,0	24,0		14	11	100
2050814	8	G1/4	11,0	20,0	24,0		14	11	100
2050838	8	G3/8	11,0	26,5	32,5		14	14	50
2051014	10	G1/4	11,0	23,5	32,0		19	13	50
2051038	10	G3/8	11,5	24,0	32,0		19	13	25
2051012	10	G1/2	14,0	30,0	33,0		17	17	25
2051238	12	G3/8	11,0	26,5	33,0		19	14	25
2051212	12	G1/2	14,0	30,0	33,0		19	17	25
2051412	14	G1/2	14,0	30,0	39,0		22	17	25
2051512	15	G1/2	14,0	30,0	37,0		24	17	10
2051612	16	G1/2	14,0	31,5	39,5		30	19	10
2051812	18	G1/2	14,0	34,0	44,0		32	22	10



ART. 206

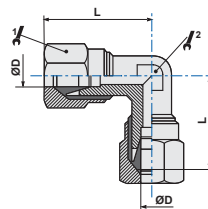

Raccordo ad L intermedio
Elbow connector

CODICE	ØD	L							
2060400	4	27,0					10	11	100
2060600	6	28,0					12	11	50
2060800	8	28,5					14	11	50
2061000	10	32,0					17	14	25
2061200	12	35,0					19	13	10
2061400	14	39,0					22	17	10
2061500	15	40,0					27	17	10



ART. 207

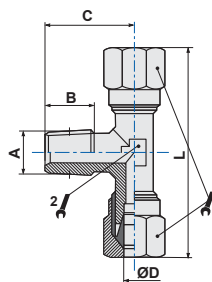

Raccordo a T centrale
Centre male tee adaptor

CODICE	ØD	A	B	C	L				
2070418	4	G1/8	8,0	16,0	42		10	9	100
2070618	6	G1/8	8,0	16,0	46		12	9	50
2070614	6	G1/4	11,0	20,0	48		12	11	50
2070818	8	G1/8	8,0	17,0	48		14	11	50
2070814	8	G1/4	11,0	20,0	48		14	11	25
2070838	8	G3/8	11,5	24,0	54		14	13	25
2071014	10	G1/4	11,0	23,5	64		19	13	25
2071038	10	G3/8	11,5	24,0	64		19	13	25
2071238	12	G3/8	11,5	25,5	69		22	15	10
2071212	12	G1/2	14,0	28,5	69		22	15	10



ART. 208

Raccordo a T laterale
Off-set male tee adaptor

CODICE	ØD	A	B	C	L				
2080418	4	G1/8	8	22,5	38,5		10	9	100
2080618	6	G1/8	8	23,5	39,5		12	9	50
2080614	6	G1/4	11	25,0	45,0		12	10	50
2080818	8	G1/8	8	26,5	46,5		14	12	50
2080814	8	G1/4	11	28,0	47,5		14	10	25
2080838	8	G3/8	11	34,5	58,5		14	13	25
2081014	10	G1/4	11	30,0	53,0		17	12	25
2081038	10	G3/8	11	34,0	60,0		17	13	25
2081238	12	G3/8	11	34,0	60,0		19	13	10
2081212	12	G1/2	14	36,0	64,0		19	17	10

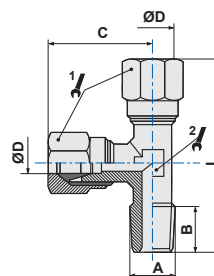

ART. 209 Raccordo a T intermedio
Tee connector

CODICE	ØD	C	L					
2090400	4	21	42			10	9	50
2090600	6	23	46			12	10	50
2090800	8	24	48			14	10	25
2091000	10	30	60			17	12	25
2091200	12	34	68			19	13	10

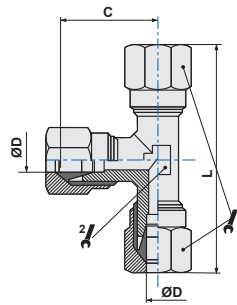
ART. 210 Dado
Nut

CODICE	ØD	A					
2100400	4	M8x1				10	100
2100600	6	M10x1				12	100
2100800	8	M12x1				14	100
2101000	10	M16x1,5				19	100
2101200	12	M18x1,5				22	100
2101400	14	M22x1,5				27	50
2101500	15	M22x1,5				27	50
2101600	16	M24x1,5				30	10
2101800	18	M26x1,5				32	10

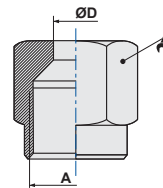
ART. 211 Ogiva
Ogive

CODICE	ØD						
2110400	4						100
2110600	6						100
2110800	8						100
2111000	10						100
2111200	12						100
2111400	14						100
2111500	15						100
2111600	16						100

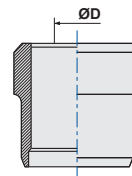

ART. 212

Boccola di supporto
Support bush

CODICE	ØD						
2120200	2,0						100
2120250	2,5						100
2120400	4,0						100
2120600	6,0						100
2120800	8,0						100
2121000	10,0						100
2121200	12,0						100

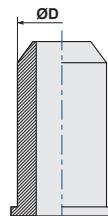

ART. 216

Raccordo ad L orientabile
Single banjo body

CODICE	ØD	G*	ØA	B	L		
2160418	4	1/8	9,8	14,5	24,5	10	50
2160618	6	1/8	9,8	14,5	26,5	12	50
2160614	6	1/4	13,2	14,5	28,5	12	50
2160818	8	1/8	9,8	14,5	25,5	14	50
2160814	8	1/4	13,2	14,5	28,0	14	50
2161014	10	1/4	13,3	14,5	32,0	17	25

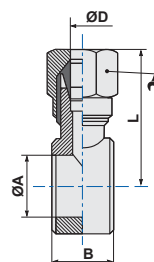
 (*) G = filetto vite/asta
 (*) G = steam thread



SCHEMA TECNICA SERIE "300" A CALZAMENTO

I raccordi a calzamento della nostra serie 300, sono realizzati in Italia, a garanzia di elevati standard di qualità, secondo le normative ISO di riferimento, e rispondono alle seguenti specifiche tecniche e applicative

FLUIDO

Aria compressa, acqua fino a 100 °C (per altri fluidi contattare il nostro UT)

APPLICAZIONI

Circuiti pneumatici, oleodinamici e idraulici

TUBI DI COLLEGAMENTO

Plastici: TPU, PE, PA, PET, PVC intrecciato, PTFE, FEP

TEMPERATURE E PRESSIONI

Le temperature e le pressioni dipendono generalmente dalle caratteristiche del tubo impiegato. La pressione massima consigliata è 18Bar

FILETTATURE

BSPP gas cilindrica ISO 228

BSPT gas conica ISO 7 - DIN 2999

Metrica ISO R/262

MATERIALI UTILIZZATI

Ottone UNI EN 12164 CW614N (nichelato)

Ottone UNI EN 12165 CW617N (nichelato)

NBR 70 DWGV-EN549 UL157 (guarnizioni tenuta)

Nylon/Alluminio (rondelle)

QUICK "300" SERIES TECHNICAL SHEET

The quick 300/400 series fittings are produced in Italy according to the reference ISO norms as warranty of high quality level and answer to the followings technical specifications and applications:

FLUIDS

Compressed air, water up to 100 °C (for different fluid pls contact our Technical Dept.)

APPLICATIONS

Pneumatic, oleodynamic and hydraulic circuits

CONNECTING TUBES

Plastic: TPU, PE, PA, PET, braided PVC, PTFE, FEP

TEMPERATURES AND PRESSURES

Temperatures and pressures usually depend by the technical features of the employed tubes. Max pressure suggested 18 bar.

THREAD TYPE

BSPP parallel UNI-ISO 228

BSPT tapered UNI-ISO 7

Metric ISO R/262

MATERIALS

Brass UNI EN 12164 CW614N (nickel plated)

Brass UNI EN 12165 CW617N (nickel plated)

NBR 70 DWGV-EN549 UL157 (seals)

Nylon/Aluminium (washers)