

SLANGEKOBLINGER, STANDARD

BAN – BANJO, BSP

Varenummer	Slangestørrelse			BSP Banjo Bolt	Dimension (mm)			
	DN	Inch	Dash		F	H	L	D
0222BAN0302	5	3/16"	-3	1/8" - 28	20,0	45,0	10,2	10,0
0222BAN0304	5	3/16"	-3	1/4" - 19	22,6	47,6	13,3	14,0
0222BAN0402	6,3	1/4"	-4	1/8" - 28	23,0	51,0	10,2	10,0
0222BAN0404	6,3	1/4"	-4	1/4" - 19	23,0	51,0	13,3	14,0
0222BAN0406	6,3	1/4"	-4	3/8" - 19	26,5	54,5	16,8	17,5
0222BAN0408	6,3	1/4"	-4	1/2" - 14	33,5	61,5	21,0	23,0
0222BAN0504	8	5/16"	-5	1/4" - 19	24,0	52	13,3	14,0
0222BAN0506	8	5/16"	-5	3/8" - 19	26,5	54,5	16,8	17,5
0222BAN0508	8	5/16"	-5	1/2" - 14	33,5	61,5	21,0	23,0
0222BAN0604	10	3/8"	-6	1/4" - 19	24,0	54,5	13,3	14,0
0222BAN0606	10	3/8"	-6	3/8" - 19	24,0	54,5	16,8	17,5
0222BAN0608	10	3/8"	-6	1/2" - 14	32,0	62,5	21,0	23,0
0222BAN0806	12,5	1/2"	-8	3/8" - 19	26,5	59,5	16,8	17,5
0222BAN0808	12,5	1/2"	-8	1/2" - 14	28,5	61,5	21,0	23,0
0222BAN0810	12,5	1/2"	-8	5/8" - 14	31,0	64,0	23,1	23,5
0222BAN0812	12,5	1/2"	-8	3/4" - 14	39,0	72,0	26,5	29,5
0222BAN1008	16	5/8"	-10	1/2" - 14	27,2	63,0	21,0	23,0
0222BAN1010	16	5/8"	-10	5/8" - 14	28,2	64,0	23,1	23,5
0222BAN1012	16	5/8"	-10	3/4" - 14	34,7	70,5	26,5	29,5
0222BAN1212	19	3/4"	-12	3/4" - 14	37,5	78,0	26,5	29,5
0222BAN1216	19	3/4"	-12	1" - 11	39,5	90,5	33,5	37,5
0222BAN1616	25	1"	-16	1" - 11	49,0	100,0	33,5	37,5

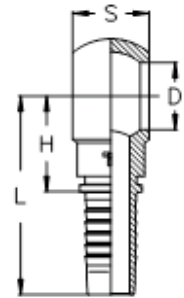

VB – BANJO BOLT, BSP

Varenummer	BSP Banjo Bolt	Dimension (mm)		
		L	L1	S
0222VB02	1/8" - 28	26,0	21,5	14
0222VB04	1/4" - 19	34,3	29,5	19
0222VB06	3/8" - 19	40,5	34,0	22
0222VB08	1/2" - 14	46,0	36,0	27
0222VB10	5/8" - 14	55,0	45,5	30
0222VB12	3/4" - 14	56,0	48,0	32
0222VB16	1" - 11	59,0	59,0	41

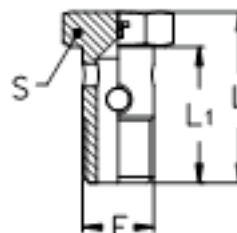

Føres også som dobbelt banjobolt på varenummer 0222VDBxx.
Data og dimensioner oplyses på forespørgsel.

SLANGEKOBLINGER, STANDARD

BAN – BANJO, Metrisk

Varenummer	Slangestørrelse			Metrisk Banjo Bolt	Dimension (mm)			
	DN	Inch	Dash		F	H	L	D
0222BAN0302 *	5	3/16"	-3	M10x1,0	20,0	45,0	10,2	10,0
0222BAN0312	5	3/16"	-3	M12x1,5	21,1	46,1	12,1	12,0
0222BAN0314	5	3/16"	-3	M14x1,5	22,6	47,6	14,2	14,0
0222BAN0402 *	6,3	1/4"	-4	M10x1,0	23,0	51,0	10,2	10,0
0222BAN0412	6,3	1/4"	-4	M12x1,5	23,0	51,1	12,1	12,0
0222BAN0414	6,3	1/4"	-4	M14x1,5	23,0	51,1	14,2	14,0
0222BAN0416	6,3	1/4"	-4	M16x1,5	26,5	54,5	16,2	17,5
0222BAN0418	6,3	1/4"	-4	M18x1,5	28,5	56,5	18,2	20,5
0222BAN0512	8	5/16"	-5	M12x1,5	23,5	51,5	12,1	12,0
0222BAN0514	8	5/16"	-5	M14x1,5	24,0	52,0	14,2	14,0
0222BAN0516	8	5/16"	-5	M16x1,5	26,5	54,5	16,2	17,5
0222BAN0516	8	5/16"	-5	M18x1,5	28,5	56,5	18,2	20,5
0222BAN0614	10	3/8"	-6	M14x1,5	24,0	54,5	14,2	14,0
0222BAN0616	10	3/8"	-6	M16x1,5	24,0	54,5	16,2	17,5
0222BAN0618	10	3/8"	-6	M18x1,5	27,0	57,5	18,2	20,5
0222BAN0620	10	3/8"	-6	M20x1,5	32,0	62,5	20,2	23,0
0222BAN0622	10	3/8"	-6	M22x1,5	32,0	62,5	22,2	22,5
0222BAN0818	12,5	1/2"	-8	M18x1,5	28,1	61,1	18,2	20,5
0222BAN0820	12,5	1/2"	-8	M20x1,5	28,5	61,5	20,2	23,0
0222BAN0822	12,5	1/2"	-8	M22x1,5	28,5	61,5	22,2	22,5
0222BAN0812 *	12,5	1/2"	-8	M26x1,5	39,0	72,0	26,5	29,5
0222BAN1022	16	5/8"	-10	M22x1,5	27,2	63,0	22,2	22,5
0222BAN1012 *	16	5/8"	-10	M26x1,5	34,7	70,5	26,5	29,5
0222BAN1212	19	3/4"	-12	M26x1,5	37,5	78,0	26,5	29,5
0222BAN1230	19	3/4"	-12	M30x1,5	41,5	82,0	30,2	36,0
0222BAN1630	25	1"	-16	M30x1,5	43,0	94,0	30,2	36,0

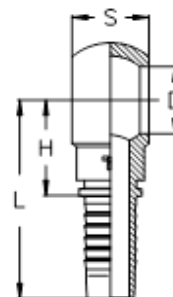

* BSP Banjo, passer til metrisk "F" mål

SLANGEKOBLINGER, STANDARD

VM – BANJO BOLT, Metrisk

Varenummer	Metrisk Banjo Bolt	Dimension (mm)		
	F	L	L1	S
0222VM10	M10x1,0	26,0	21,5	14
0222VM12	M12x1,5	31,0	25,5	17
0222VM14	M14x1,5	37,5	30,5	19
0222VM16	M16x1,5	40,5	34,0	22
0222VM18	M18x1,5	44,0	36,5	24
0222VM20	M20x1,5	48,0	39,5	27
0222VM22	M22x1,5	50,0	41,5	28
0222VM26	M26x1,5	58,0	48,5	32
0222VM30	M30x1,5	64,0	53,0	36

